

WARNING

Buyer/User assumes all responsibility for safety and proper use not in accordance with the directions and safety labels.



UFO Aquarium Kit

- * Corner bow front
- * Equipped with a complete hood with PL lamps
- * Complete biological filtration



Congratulations for purchasing a ViaAqua® self-contained aquarium kit!
All ViaAqua® aquarium kits can be used for either saltwater or freshwater environments.

Having a well-maintained and established aquarium in the house or office provides a soothing and tranquil feeling for all. It is known that aquariums and fish help reduce stress and anxiety. A child's love for fish can be used to teach responsibility as well as basic biology.

The following are some helpful hints as well as specific guidelines to set up and maintain an aquarium. These are guidelines and cannot account for every variable in owning and/or taking care of an aquarium with live animals.

We recommend that when having any questions always consult your local tropical fish store or pet supply store. Please follow these guidelines for a successful aquatic environment.

WARNING

- » This product may contain chemicals known to the State of California to cause cancer and/or birth defects or other reproductive harm. Wash you hand after handling the product.
- » It is your sole responsibility to verify that the plug and receptacle are clean/free of moisture and salt build up at all times. The receptacle must be free of water, salt, calcium, and magnesium. Failure to do so may cause fire and/or loss of life.
- » Do not plug into an extension cord or power strip.
- » A drip loop must be used when plug into any electrical devices. A drip loop is part of the cord hanging below the receptacle.
- » The national code requires all aquarium equipment to be plugged into a G.F.C.I. (Ground Fault Circuit Interrupter) electrical outlet. If you do not have a G.F.C.I., have an electrician install one prior to operating any aquarium components.

PRECAUTIONS AND WARNING

Before installing a ViaAqua® Aquarium Kit Read and Follow all warnings and safeguards and to guard against injury, basic safety precautions need to be observed.

- * Read and follow all warning and instructions.
- * The aquarium must be placed on a strong and level aquarium stand.
- * If the light hood is to fall into the water or is sitting in water do not reach for it. Unplug the light fixture first then retrieve and/or remove. If the light is to get wet unplug immediately.
- * Always unplug all electrical devices prior to working on the aquarium and/or filter.
- * Do not operate if any of the electrical cords are damaged.
- * Never yank or pull the cord from the electrical outlet.
- * Only use the aquarium for it intended use.
- * Do not lift the aquarium with water inside.
- * Do not operate the pump without water.
- * All components are intended for indoor use only.

INSTALLATION

First decide on what kind of fish you would like to keep.

- Goldfish-coldwater
 - Tropical fish
 - Saltwater aquarium
 - Planted aquarium
 - Reef aquarium
1. On a perfectly flat surface fill the aquarium with water to verify that there are not any leaks. Now that there are not any leaks remove the water from the aquarium. Never lift the aquarium with water either scoop or siphon water from the aquarium.
 2. Guidelines for aquarium location.
 - a. Do not put the aquarium directly in the front of a window
 - b. Do not put next to a door that leads to the outside. Any consistent draft will make it very difficult to maintain a stable temperature
 - c. If you are not placing the aquarium on an aquarium stand verify that the surface is flat, level and strong. Note that water weights approximately 8 lbs. per gallon
 - d. Keep out of reach of children

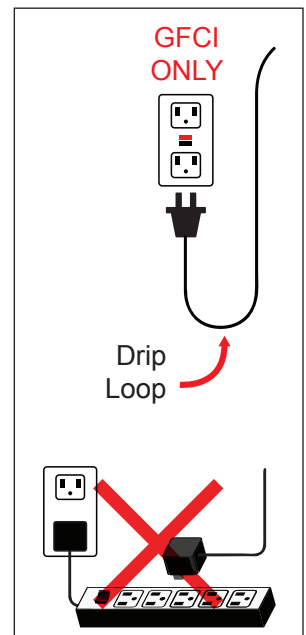

3. Electrical supply
 - a. Plug in all electrical aquarium appliances into a G.F.C.I. electrical outlet only
 - b. Do not plug into an extension cord
 - c. Always disconnect the power to all aquarium devices prior to maintenance
 - d. Do not plug in the pump until the aquarium is full of water.
 - e. Remove the light hood and set aside
4. Attach the intake tube to the intake strainer. Both pieces are found inside to the filter
5. Now attach the intake tube/intake strainer to the intake or bottom of the pump
6. Now place the filter on top of the aquarium. The filter is to be placed so that the pump is on the left side of the aquarium.
7. Remove the biological media and rinse well.
8. Now place the biological media on the bottom of the filter.
 - a. Models UFO700 and UFO880 have dual stage biological filters
 - b. Evenly disperse biological media in both stages.
 - c. Note biological media is not to be replaced. Clean media with tank water only. Tap water will kill beneficial bacteria, which keeps the aquarium stable.
10. Place the filter pads on the top of the biological media. Optional: ViaAqua® carbon cartridges and filter pads can be used.
 - a. A small amount of carbon and/or resin filtering media is recommended. Place the media in a filtering bag and insert into the filter.
11. Now install the spray bar so that the holes in the spray bar are facing down. Now the filter is ready to be used.
12. Rinse gravel well. It is recommended to use 1 lb. of gravel per gallon.
13. Fill tank with water. When filling the tank with water verifies that the container is clean and not contaminated. The water level should be just below the small holes on the bottom of the filter.
14. When keeping Tropical fish or a saltwater aquarium a ViaAqua® heater is recommended. Please consult your local tropical fish store or pet supply store for the proper wattage heater.
 - a. UFO 350: 50-75 watt ViaAqua® preset heater
 - b. UFO 550: 100-150 watt ViaAqua® preset heater
 - c. UFO 700: 200 watt ViaAqua® preset heater
 - d. UFO 880: 250-300 watt ViaAqua® preset heater
15. Place a thermometer on the opposite side of the heater.
16. Install the heater according to the manufactures guidelines.
 - a. Wait 15 minutes for the heater to acclimate to the water temperature in the aquarium prior to plugging the heater into a G.F.C.I. electrical outlet.
 - b. Place the heater where there is good water circulation.
17. Due to varying water conditions water supplements may be necessary, consult with your local tropical fish store or pet supply store for the required water conditioners for your area.
18. Plug in the filter into a G.F.C.I. electrical outlet. Verify the filter is working properly. This can be done by verifying water is discharging from the small holes on the bottom of the filter.
19. Place the light hood on the aquarium.
20. Place the filter lid onto the filter.
21. Confirm that there are not any leaks.
22. Once the temperature is stable you are ready for fish and plants.

BASIC GUIDELINES

Keeping Tropical fish is easy once you understand the basics. Every aquarium is a self-contained ecosystem. Meaning that water, fishes, plants and nitrifying bacteria all work together to maintain a stable environment. At first the aquarium is not balance because the nitrifying bacteria have not had a chance to cultivate in the biological media. The introduction of nitrifying bacteria will help speed up the biological cycle and create a healthy environment for your fish. Adding the bacteria is not an instant solution but will greatly improve set up of any new aquarium. Now, add few fishes and plants, as this will start your biological cycle.

Consult your local tropical fish store or pet supply store for a few hearty fish and plants. Now it will take a little patience since it is a natural process there is not an exact time frame as when the biological cycle will end. To verify that the biological cycle is complete test the water for ammonia and nitrite. If both the ammonia and nitrite are at 0.0 ppm you are ready to slowly stock your aquatic environment. Adding fish weekly is recommended so the environment has time to adjust to the increased biological load. Two weeks after the biological cycle is complete change 25-30% of the water once a month.

Remember these are only guidelines and not rules of aquarium set up. Set up can vary depending on local water conditions and the type of fish or animals you would like to keep. A good tropical fish store or pet supply store can assist with good advice.

AQUARIUM AND CABINET

Item no.	Color	Dimensions (approx.)	Capacity	Light Bulb	UPC #0069037
UFO 350-B	Black	19"L x 12"W x 17 3/4"H	9 gal.	1 x 13w Daylight	2970 3
UFO 350-S	Silver				2997 0
UFO 550-B	Black	30 3/4"L x 19"W x 24 1/2"H	15 gal.	2 x 13w Daylight	2971 0
UFO 550-S	Silver				2998 7
UFO 700-B	Black	38"L x 24"W x 27 1/2"H	55 gal.	3 x 20w Pink	2701 3
UFO 700-S	Silver				2703 7
UFO 880-B	Black	47 1/2"L x 30"W x 29 1/2"H	90 gal.	2 x 30w Pink 1 x 20w Pink	2705 1
UFO 880-S	Silver				2707 5

Aquarium Cabinet

Item no.	Aquarium Model	Color	Description	Dimension (approx.)	UPC #0069037
UFO 350KD-B	UFO 350	Black	High density compress board Full size aquarium cabinet	19" L x 12" W x 28" H	3033 4
UFO 350KD-S		Silver			3034 1
UFO 550KD-B	UFO 550	Black		30 3/4" L x 19" W x 28" H	3035 8
UFO 550KD-S		Silver			3036 5
UFO 700KD-B	UFO 700	Black		38 1/2" L x 24" W x 28" H	2702 0
UFO 700KD-S		Silver			2704 4
UFO 880KD-B	UFO 880	Black		48" L x 30 1/4" W x 28" H	2706 8
UFO 880KD-S		Silver			2708 2

- * Do not add all the fish and plants at one time.
- * See your local tropical fish store for proper new tank setup.
- * An additional life support system is recommended.
- * Aeration-aids in good gas exchange or use of a secondary water circulating pump.

LIMITED WARRANTY

Commodity Axis Inc. warrants that the ViaAqua® Aquarium kit is free from defects for a period of one year from the initial date of purchase shown with the original cash register receipt. Commodity Axis Inc. disclaims all other warranties of merchantability and/or fitness for a particular purpose. Although this limited warranty may give you specific rights, you may have other rights that may vary from state to state. This warranty is void if the failure of the ViaAqua® Aquarium kit or any part, sealant or component there of is due to (i) misuse, (ii) tampering, (iii) negligence, (iv) misapplication, (v) abuse, (vi) accident and/or (vii) failure to properly (a) maintain, (b) clean, (c) keep in contact with water and or use the ViaAqua® Aquarium Kit with a Ground Fault Circuit Interrupter (G.F.C.I.).

CONSUMER REMEDIES

Commodity Axis Inc. entire liability and your sole exclusive remedy be, either the repair or replacement of the ViaAqua® Aquarium Kit only if the return the defective ViaAqua® Aquarium Kit directly to Commodity Axis Inc. with the original cash register receipt in this original box along with \$25.00 for shipping and handling. Do not send the ViaAqua® Aquarium Kit by insured mail. The ViaAqua® Aquarium Kit may be sent by UPS requiring a signature on arrival. Any replacement of ViaAqua® Aquarium Kit will be warranted for the remaining for the original warranty period. In no event will shipping charges be reimbursed. In not event will Commodity Axis Inc. be liable for any consequential or incidental damages including, but not limited to loss of life, personal injury, property damage, damaged equipment, lost profits, lost wages, lost savings, lost income, etc. Some states do not allow for the limitations or exclusion of liability for incidental or consequential damages, so the above exclusion may not apply to you.

UFO AQUARIUM REGISTRATION CARD ONE (1) YEAR WARRANTY

Name		Date
Address		
City	State	Zip code
Country	Home phone	
Cell phone	Email	
Date of purchase		Seller (Retail Name)
Seller's Location		Phone

*Affix a copy of your original purchase receipt here.

Please mail warranty card and proof of purchase within 15 days of purchase to:
Commodity Axis® Inc., P.O. Box 1210, Camarillo, CA 93012.
Fax: (888) 989-0878 www.ViaAquaOceanpure.com

**IMPORTANT: Please make a copy of this warranty card and retain it for your records.
Warranty policy is subject to change without notice. August 2009.**